

Photoelectric sensors

OG5116

OGS-OOKG/V4A/US
Through-beam sensor
Threaded type M18 x 1
Quick disconnect

gold-plated contacts
Transmitter

Sensing range 15m

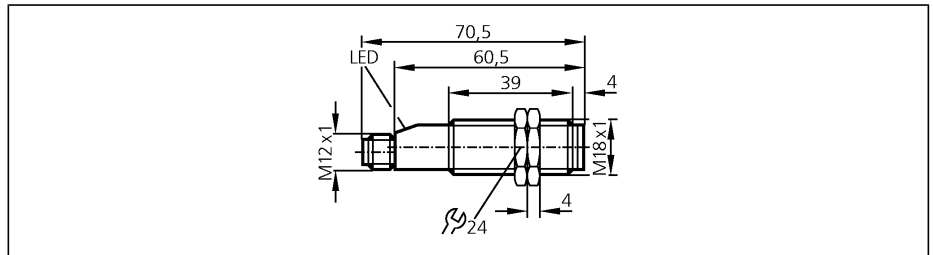

Electrical design	
Light spot diameter	[mm]
Operating voltage	[V]
Short-circuit protection	
Reverse polarity protection	
Overload protection	
Current consumption	[mA]
Type of light	
Operating temperature	[°C]
Protection	
EMC	
Housing material	
Material lens	
Function display	
Power	LED
Connection	
Accessories (included)	

DC	
Light spot diameter	2000 (RW = max.)
Operating voltage	10...36 DC
Short-circuit protection	Yes (non-latching)
Reverse polarity protection	yes
Overload protection	yes
Current consumption	< 17
Type of light	transmitter infrared 880 nm
Operating temperature	-25...80
Protection	IP 68 / IP 69 K, II
EMC	EN 60947-5-2
EMC	EN 55011: class B
Housing material	stainless steel (316S12); PBT
Material lens	PMMA
Function display	green
Power	LED
Connection	M12 connector; gold-plated contacts
Accessories (included)	2 lock nuts

Wiring

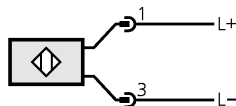

Photoelectric sensors

OG5117

OGE-FPKG/V4A/US
Through-beam sensor
Threaded type M18 x 1
Quick disconnect

Function check output
gold-plated contacts
Receiver

Sensing range 15m
adjustable

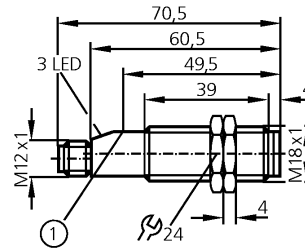

1: push button



Electrical design

Output

Operating voltage	[V]
Current rating	
Switching output	[mA]
Function check output	[mA]
Short-circuit protection	
Reverse polarity protection	
Overload protection	
Voltage drop	
Switching output	[V]
Function check output	[V]
Current consumption	[mA]
Switching frequency	[Hz]
Type of light	
Operating temperature	[°C]
Protection	
EMC	
Housing material	
Material lens	
Function display	
Switching status	LED
Power	LED
Function	LED
Connection	
Accessories (included)	

DC PNP

light-on / dark-on programmable

10...36 DC
200
10
Yes (non-latching)
yes
yes
< 2.5
< 3.5
< 24
500
receiver infrared light 880 nm
-25...80
IP 68 / IP 69 K, II
EN 60947-5-2
EN 55011: class B
stainless steel (316S12); PBT
PMMA
yellow
green
red
M12 connector; gold-plated contacts
2 lock nuts

Wiring

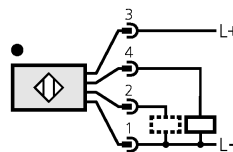
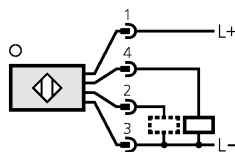

2: function check

OG5117

excess gain graphs

